

31.4 m 2005 Astondoa 102 GLX

€2,550,000

Mallorca, Spain

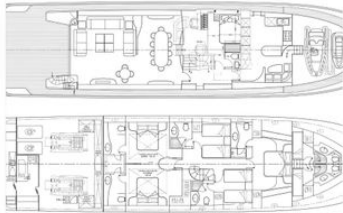

Boat Details

| | | | | | |
|------------|-------------------|----------------|------------------------|--------------|------------------|
| Make: | Astondoa | Class: | Motor Yacht | Crew Cabins: | 3 |
| Model: | 102 GLX | Hull Material: | Fiberglass | Guest Heads: | 6 |
| Year: | 2005 | Drive Type: | Shaft Drive | Crew Heads: | 3 |
| Length: | 31 m 45 cm | Beam: | 7 m 3 cm | Fuel Type: | Diesel |
| Price: | €2,550,000 | Boat Location: | Mallorca, Spain | Max Draft: | 2 m 20 cm |
| Condition: | Used | Guest Cabins: | 6 | | |

Jean Lacombe | Allied Yachting Cannes

Boulevard de La Croisette, Port Canto, Cannes, Alpes-Maritimes, France

Tel: +33 (0)493 43 82 83 Fax: +33 (0)492 59 11 05

jlacombe@alliedyachting.com

<http://www.alliedyachting.com>

Description

This prime example 31.45-meter ASTONDOA 102 GLX motor yacht for sale built in 2005 by the renowned Spanish shipyard Astondoa is perfectly maintained and has undergone a one million Euro extensive refit in winter 2022, for which the Owner has spared no expense. She is presented like a brand-new yacht, fully serviced and finds herself in pristine condition with a successful charter record.

This large flybridge yacht is a well-proportioned fibreglass vessel which represents the “Astondoa style”, accentuated by modern, sporting lines, at the same time being extremely elegant, both inside and out. The ASTONDOA 102 GLX design participates in the most recent trends but has its own distinctive personal touches, which combine various aesthetic elements creating the yacht's personality.

The ASTONDOA 102 GLX is classified as a raised pilothouse yacht, with two and a half decks and a command bridge located between the main deck and the flybridge. Her profile features three large lateral windows, the largest of which illuminates the saloon. The window on the bow illuminates the service areas whereas the upper lateral window is the natural continuation of the windscreen of the command bridge.

With her recent refit featuring state-of-the-art updates and upgrades, she offers an evolution in her 6-cabin layout, design and construction. She can now comfortably accommodate up to 12 guests in the lower deck, including a Master cabin with king size double bed and private en-suite, 2 VIP cabins with double beds and 2 twin cabins with single bed + 1 Pullman bed. The Captain's cabin on the main deck can also be utilized as an additional guest cabin. All cabins have en-suite facilities with shower room.

She features an elegant and comfortable main saloon fitted with carpets and soft furnishings. The adjoining dining area is just forward of the saloon where guests can dine indoors in a formal atmosphere. There is also the opportunity to dine in the fresh air on the aft deck where up to 16 guests can be seated. There are additional sunpads forward of the yacht and aft of the flybridge.

Fitted with zero speed stabilizers and powered by twin 2285 Hp MTU Diesel engines, she reaches a top speed of 25 knots, while cruising at 18 knots.

Viewings are highly recommended in Spain.

KEY FEATURES

- 2022 Refit
- Successful charter yacht
- 12 Guests in 6 en-suite cabins: 1 Master, 2 Double, 2 Twin with Pullman + 1 Double on the main deck (in process)
- Turn-key condition - excellent maintenance schedule
- Zero speed stabilizers (at anchor and underway)

Please click on the « Other Details » tab for complete specifications of this large Flybridge Yacht for Sale.

Information & Features

MTU 12V 396 TE94 (Engine 1)

| | | | |
|--------------|--------------------|--------|----------------|
| Engine Type: | Inboard | Power: | 2285 hp |
| Fuel Type: | Diesel | | |
| Drive Type: | Shaft Drive | | |

MTU 12V 396 TE94 (Engine 2)

Engine Type: **Inboard** Power: **2285 hp**
Fuel Type: **Diesel**
Drive Type: **Shaft Drive**

Dimensions

LOA: **31 m 45 cm** Max Draft: **2 m 20 cm**
LWL: **27 m 80 cm** Gross Tonnage: **169**
Beam: **7 m 3 cm**

Accommodations

Guest Cabins: **6** Crew Heads: **3**
Crew Cabins: **3**
Guest Heads: **6**

Other

Hull Shape: **Planing** Builder: **Astilleros Astondoa S. A. (Spain)**
Flag Of Registry: **Spain**
Designer: **Astondoa Group / Owner**

Disclaimer

These particulars are given in good faith as supplied to us but cannot be guaranteed and cannot be used for contracts

Full Specs

MAIN CHARACTERISTICS

Builder: Astilleros Astondoa S.A. (Spain)

Model: Astondoa 102 GLX

Type: Motor-Yacht / Flybridge Yacht / Raised Pilothouse

Hull Type: Planing

Hull Material: Fiberglass

Superstructure Material: Fiberglass

Decks: Teak

Year Built: 2005

Refit(s): 2022

LOA: 31.45 m (103' 3")

LWL: 27.80 m (91' 2")

Beam: 7.03 m (22' 10")

Maximum Draft: 2.20 m (7' 3")

Displacement: 114,410 kg (252,231 lb)

Gross Tonnage: 169 GT

Class: Spanish Commercial Yacht

Flag of Registry: Spain

Location: Mallorca, Spain

PROPULSION

Type / Fuel: Twin Diesel

Main Engines: 2 x 2285 Hp (1704 kW) MTU 12V 396 TE94

Engine Hours: 1950 h (Dec. 2022)

Engine Type: Inboard

Drives: Shaft

Maximum Speed: 25 knots

Cruising Speed: 18 knots

Consumption: 600 l/h

Gearboxes: 2 x ZF

Flaps: BCS

TANKAGE

Fuel Capacity: 10,800 l (2853 US gallons)

Fresh Water Capacity: 3,500 l (925 US gallons)

Holding Tank: 1,500 l (396 US gallons)

ACCOMMODATION

12 Guests in 6 en-suite staterooms

Guest Cabin Configuration:

- Full width forward Master stateroom with large King-size bed, vanity and en-suite bathroom
- 2 x VIP cabins port and starboard, each with double bed, closets and en-suite bathroom
- 2 x Twin guest cabins port and starboard, each with 2 single beds, closets, en-suite bathroom and additional Pullman bed
- 1 x Double cabin in upper deck with closet and en-suite bathroom (in process)

Main deck large saloon with dining area, large fully equipped galley, crew mess and access to crew cabins

Main helm in raised pilothouse

Crew Accommodation for 5:

- 2 x Bunk-bedded double crew cabins with 2 bathrooms fore
- Captain's cabin with bathroom

Large cockpit with teak table and seating for up to 16

Exterior day-head on main deck port with washbasin and toilet

Flybridge with sunbed, dining table, pantry cabinets and outdoors helm

Interior furniture in wood

Electric saloon door

MAIN EQUIPMENT

ABT Trac zero speed fin stabilizers (at anchor and underway)

BCS bow thruster

BCS stern thruster

Hydraulic flaps

IDROMAR 160 l/h water maker (new)

TECMA toilet system

CONDARIA Domestic reversible air conditioning/heater throughout

ELECTRICAL

Generators: 2 x 33 kW KOHLER Diesel

Genset hours: 3675 h (Dec. 2022)

Emergency Generator: 1 x 17.5 kW KOHLER

Emergency Genset Hours: (N/D)

Battery chargers: MASTERVOLT

Converter: MASTERVOLT

Shore power: 220/240V

Inverter: Custom

Set of service batteries

Set of emergency batteries

Set of engine(s) start batteries

Set of generator(s) start batteries

Set of independent batteries for bow garage operation

Shore power inlet

Cable master

NAVIGATION EQUIPMENT

MTU electronic engine controls
MTU electronic engine displays
QS80 QUICKSTICK remote unit with screen
Radar FAR-1523BB
Radar antenna XN13A
HATTELAND screens on bridge and fly
SIMRAD A2004 autopilot
Display IS42
WS310 wind pack
SIMRAD RS100 VHF + handset and speakers
FLIR thermal camera M232
Main Computer Integrated System
Weather fax NAVTEX w/printer GRC NCR 330
Loch-speedometer RAYMARINE
Echo-sounder RAYMARINE
Anemometer RAYMARINE ST 290
Gyrocompass: SIMRAD AR 78
Satellite phone INTELLIAN
Rudder angle indicator RAYMARINE ST 290 YACHT ICA
Repeaters on flybridge

GALLEY/CREW MESS/DOMESTIC EQUIPMENT

AEG microwave
7 x Custom design ASTONDOA refrigerator/freezer units
AEG electric burners
GARCIA hood extractor
AEG oven
RANCILIO IBS 24.6 ice maker
AEG dishwasher
2 x Inox stainless-steel sinks with taps
NESSPRESSO coffee machine
PHILIPS toaster
SIEMENS kettle
2 x AEG washer & dryer units in lazarette
ISOTHERME fridge in lower deck hall

ENTERTAINMENT

New sound system REVOX & SONANCE
INTELLIAN satellite TV antenna
TELTONIKA 5G Wi-Fi internet router
Brand new Smart TVs in all cabins, saloon and crew mess

Home cinema
Radio/CD/DVD & Blu-Ray players in all cabins
Interphone in all cabins
Digital satellite decoder in saloon and all cabins
Cockpit speakers
Flybridge speakers

DECK EQUIPMENT

Cockpit 3rd. helm station
MOR SAVERIO hydraulic telescopic gangway
Teak decks throughout, including flybridge
Large swim platform
Swim platform hot/cold shower
2 x LOFRANS electro-hydraulic windlasses
2 x Galvanized stainless-steel anchor chains
2 x Galvanized stainless-steel anchors
2 x LOFRANS electric mooring winches (foot controlled)
Bow tender garage with opening mechanism
MOR SAVERIO bow tender crane (in garage)
Set of fenders (14)
OPACMARE swim ladder
Cockpit fridge
Cool box
Cockpit speakers
Cockpit dining table in teak for up to 16 Guests
Folding teak Director's chairs
Full set of cushions cockpit and bow deck

FLYBRIDGE

Helm station with repeaters
2 x Fridges
Cool box
Sink, Inox stainless-steel with tap
Cabinet with pantry
4 x Speakers
Electric awning
Full set of cushions flybridge

COVERS

Cockpit, side & windshield covers
Electric opening bimini on flybridge
Electric opening canvas behind cockpit/transom

SAFETY EQUIPMENT

2 x Life buoys on flybridge
2 x SOLAS liferafts 10 pax on flybridge
11 x Powder extinguishers 6kg throughout
1 x CO2 extinguisher 5kg
HFC 227 Gas system extinguisher garage
HFC 227 Gas system extinguisher engine room FM 200
17 x Life jackets throughout
2 x SOLAS medical kits
4 x Parachute flares
2 x Smoke signals
14 x Smoke detectors throughout
2 x Portable VHF's
Camera stern
Camera engine room

TENDERS & WATERSPORTS

NOVURANIA 400 DL (2005) + engine YAMAHA 50 Hp (new)
SEA DOO Spark Trixx Jet-ski (new 2022)
Wakeboard
Water skis
2 x Paddle boards
Doughnut
Snorkeling equipment
2 x Seabobs

REFIT 2022

Conversion to 6 cabin layout
New exterior furniture + fabrics + covers
Main deck new interior furniture + carpets
2 x Brand new refrigerated wine cellars
New sound system REVOX & SONANCE
Comprehensive maintenance of the systems of the entire yacht with updates
New ABT Trac stabilizer system
New security and fire extinguishing elements
Chain + anchor modification
New bimini + canopy
New life raft cradles + new SOLAS rafts
New security and fire extinguishing elements
QS80 QUICKSTICK remote unit with screen
Radar FAR-1523BB

Radar antenna XN13A
HATTELAND screens on bridge and fly
SIMRAD A2004 autopilot
Display IS42
WS310 wind pack
SIMRAD RS100 VHF + handset and speakers
FLIR thermal camera M232
INTELLIAN satellite TV antenna
TELTONIKA 5G Wi-Fi internet router
Brand new Smart TVs
Brand new refrigerators fly & aft deck

Yacht Brochure

Available upon request.

Inspections

Prior appointment, please. 4 day notice greatly appreciated.

Berth

Berth place management possible on French or Italian Riviera as well as Spain (Mainland and Balearic Islands), Greece and Turkey.











